

# DAS TAPPERS - UNEQUAL DIVIDERS

350-5850 MHz

UD-XXN/D Wideband Low Loss Power Tappers/Unequal Dividers/Signal Samplers

## Common Specifications

Frequency Range:	350 - 5850 MHz (per table)
Maximum Input Power:	300 Watts Avg., 3kW Peak, any port
Ohmic/Dissapative Insertion Loss:	0.17 dB (4.8%)
PIM:	160 dBc Max
Impedance:	50 Ohms
Connectors:	Flange mount Type-high mating torque Female standard, Male available, any combination
DC Continuity:	J1 ↔ J3
Material and Finish:	Aluminum 6061 with clear Iridite
Environmental:	IP67, Approved for outdoor use
Weight:	6 Oz Type N, 8 Oz Din
Mounting:	Tapped holes-Bracket and screws supplied

NOTE: VSWR not specified for port J2

## Typical Part Number

<b>UD-05XXX</b> Part Number   Connector ID	Connector:	Connector ID:
	Type N	N
	7-16 DIN	D
	4.1-9.5 MINIDIN	D41
	4.3-10.0 MINIDIN	D43

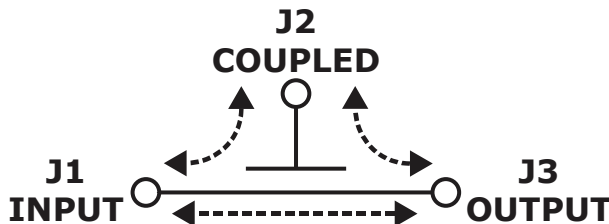

## Made in USA

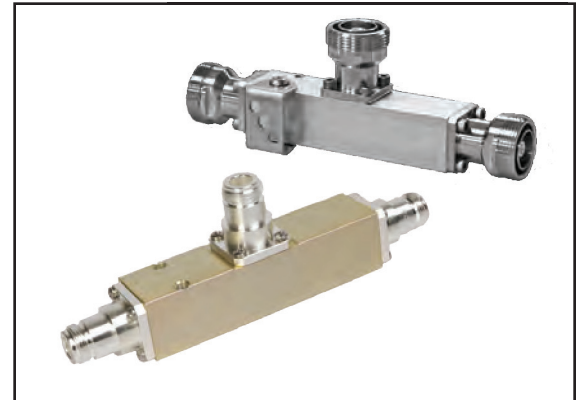

R&D Microwaves Unequal Power Dividers (re-active splitters) utilize a unique airline distributed capacitor construction that provides the lowest insertion loss, input VSWR, high power, and exceptional low PIM performance. The UD series are available in 1 dB coupling value increments up to 16 dB, with the highest values up to 30 dB, providing split ratios from 2:1 up to 1000:1. The units are provided with high torque connectors that are flange mounted to the housing chassis with O-rings for sealing for a robust and reliable connection. Mounting brackets and screws are supplied for easy wall mounting applications. All units achieve an IP68 environmental rating and are 100% tested to assure PIM spec compliance.

Highlighted Columns are GUARANTEED AND TESTED for each Unit, Unhighlighted Columns are typical or nominal values

Part Number	Coupling (dB)	Split Ratio J3:J2	Coupling (dB)		Nom. Cplng (dB)	Guaranteed Coupling (dB)		Nominal Coupling (dB)		Return Loss J1	
			J1 ↔ J2	J1 ↔ J3		380-520	698-960 1710-2700	3500-4500	4900-5850	(1)	350-5850
UD-05	5	2:1/3dB	4.8	1.8	4.4	5 ± 0.5	4.9 ± 0.6	4.0	5.0	19.0	15.0
UD-06	6	3:1/4.8dB	6.0	1.3	6.5	6.4 ± 0.4	6.4 ± 0.7	6.0	5.4	19.8	15.0
UD-07	7	4:1/6dB	7.0	1.0	7.4	7.2 ± 0.3	7.2 ± 0.7	6.7	6.5	19.8	14.7
UD-08	8	5.3:1/7.25dB	8.0	0.8	8	8.3 ± 0.4	7.7 ± 0.5	7.4	8.5	19.8	17.5
UD-09	9	7.0:1/8.5dB	9.0	0.6	9	9 ± 0.3	9.3 ± 0.6	8.2	9.6	19.8	19.8
UD-10	10	9.0:1/9.5dB	10.0	0.5	10.1	10.1 ± 0.4	10.4 ± 0.8	9.0	11.1	20.8	17.7
UD-11	11	12:1/10.6dB	11.0	0.4	11.2	11.2 ± 0.3	11.4 ± 0.7	10.5	11.5	20.8	17.7
UD-12	12	15:1/12dB	12.0	0.3	12.2	12.1 ± 0.3	12.4 ± 0.7	11.5	13.0	20.8	17.7
UD-13	13	19:1/13dB	13.0	0.2	13	13 ± 0.3	13.3 ± 0.6	12.5	13.3	23.1	15.7
UD-14	14	24:1/14dB	14.0	0.2	13.7	13.8 ± 0.3	14.1 ± 0.6	13.2	14.9	19.8	10.8
UD-15	15	30:1/15dB	15.0	0.1	14.8	14.9 ± 0.3	15.5 ± 0.9	13.7	16.2	20.8	19.8
UD-16	16	39:1/16dB	16.0	0.1	15.7	15.7 ± 0.3	16.5 ± 1	14.5	17.7	20.8	17.7
UD-20	20	100:1/20dB	20.0	0.1	20.2	20.2 ± 0.6	20.9 ± 1.2	19.5	27.6	23.1	20.8
UD-25	25	316:1/25 dB	25.0	0.1	25	25 ± 1	25 ± 1.2	25.0	26.0	20.0	20.0
UD-26	26	398:1/26 dB	26.0	0.1	26	26 ± 0.8	26 ± 1.5	26.0	26.0	20.0	20.0
UD-28	28	631:1/28 dB	28.0	0.1	28	28 ± 1	28 ± 1.5	28.0	25.0	20.0	20.0
UD-30	30	1000:1/30dB	30.1	0.1	29	30 ± 1	31 ± 1.8	24.9	31.5	23.1	20.8

(1) SPECIFIED OVER 698-960 & 1710-2700 MHz



R&D Microwaves LLC, 301 Rockaway Valley Road, Boonton, NJ 07005 USA  
 Tel. 908.212.1696 www.rdmicrowaves.com  
 email: sales@rdmicrowaves.com



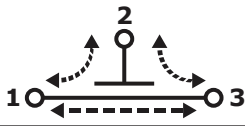

# DAS TAPPERS - 380-5850 MHz UNEQUAL DIVIDERS

UD-XXN/D Wideband Low Loss Power Tappers/Unequal Dividers/Signal Samplers

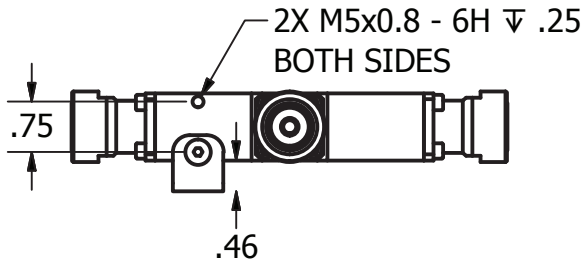

Mounting Brackets  
& Screws Supplied

